

30,000 to
104,772 SF



Constellation Commerce 360

951 E. Avenue K, Grand Prairie, TX 75050



Available for Lease



green  ready



Divisible to
30K SF

32'
clear height

0.5 miles from
HWY 360

4.5 miles from
DFW Airport

Building 1.....	LEASED
Building 2.....	104,772 SF

Total **104,772 SF**

- Premier infill location in the GSW submarket of Dallas/Fort Worth
- Located .5 miles from Hwy 360, 1.5 miles from I-30, and 4.5 miles from the South entrance of the DFW airport
- State-of-the-art buildings featuring 32' clear height and multiple points of access
- Designed to achieve LEED Certification with "Green Ready" features including conduit for EV charging stations



30,000 to 104,772 SF



Constellation Commerce 360

951 E. Avenue K, Grand Prairie, TX 75050

Available for Lease

BUILDING 1 DETAILS

- 95,800 SF
- Divisible to - 30,000 SF
- Spec Office Space: 2,755 SF
- 20 dock high doors
- 2 ramped doors
- 32' clear height
- 54' x 46'-8" bays with 60' speed bays
- ESFR
- 58 car parks
- 200' shared truck courts

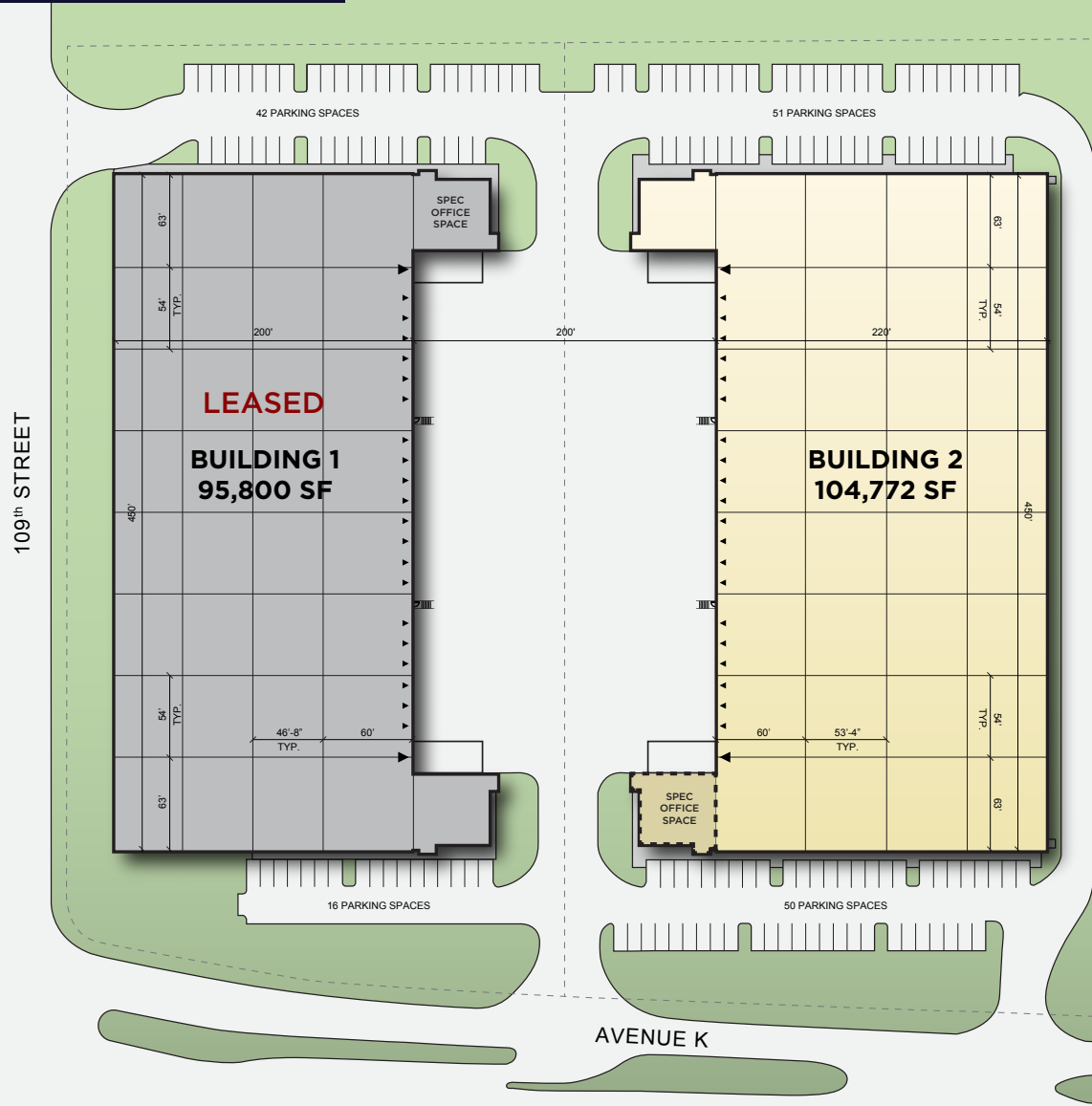

BUILDING 2 DETAILS

- 104,772 SF
- Divisible to - 30,000 SF
- Spec Office Space: 2,747 SF
- 20 dock high doors
- 2 ramped doors
- 32' clear height
- 54' x 46'-8" bays with 60' speed bays
- ESFR
- 101 car parks
- 200' shared truck courts



David Eseke, SIOR

Vice Chairman
972.663.9852 | Direct
805.637.9966 | Mobile
david.eseke@cushwake.com

Clay Balch

Managing Director
972.663.9853 | Direct
972.742.9234 | Mobile
clay.balch@cushwake.com



Scott Ellerman

Senior Vice President
214.814.4310 | Direct
214.208.1007 | Mobile
scotte@constellationrep.com

Natalie Yammine

Development Associate
214.984.3797 | Direct
817.455.2569 | Mobile
nataliey@constellationrep.com

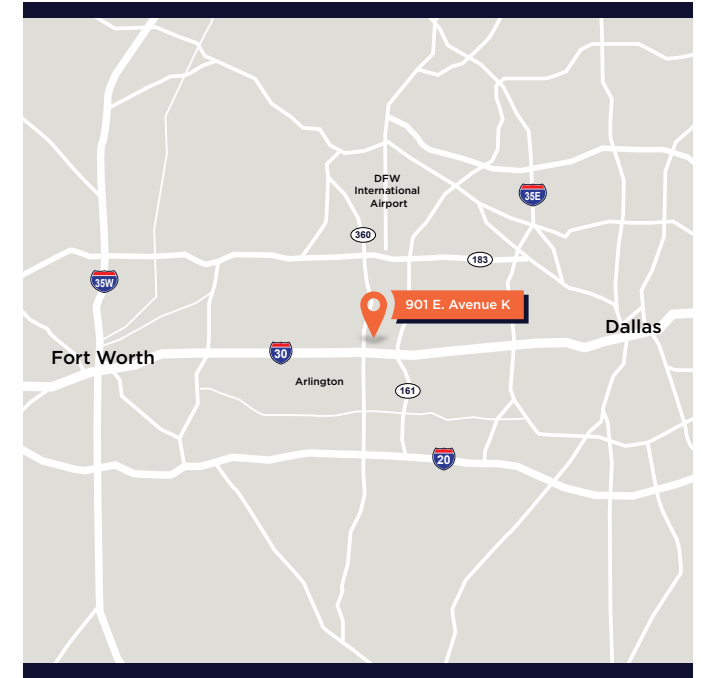



30,000 to
104,772 SF



Constellation Commerce 360

951 E. Avenue K, Grand Prairie, TX 75050

Available for Lease

 Ingress
 Egress

4.5 miles DFW Airport

14 miles to
Downtown Dallas



Constellation Commerce 360

0.5 miles to 360

15 miles to
Downtown Fort Worth



1.5 miles to I-30